



NOTICE TO RESIDENTS NEAR THE GEORGE WASHINGTON MEMORIAL PARKWAY AND I-495 INTERCHANGE

Pile Driving for New Ramp Overpasses Planned April 19 through May 16

What's Happening?

Pile driving to construct the northern abutments of two future overpass ramps connecting the George Washington Memorial Parkway and I-495 (Capital Beltway) is planned to occur during daytime hours beginning on or about April 19 through May 16, 2024.

What Should Neighbors Expect?

Pile driving involves hammering steel beams into the ground to support the foundation of the future ramps. When active, neighbors will hear hammer strikes every few seconds.

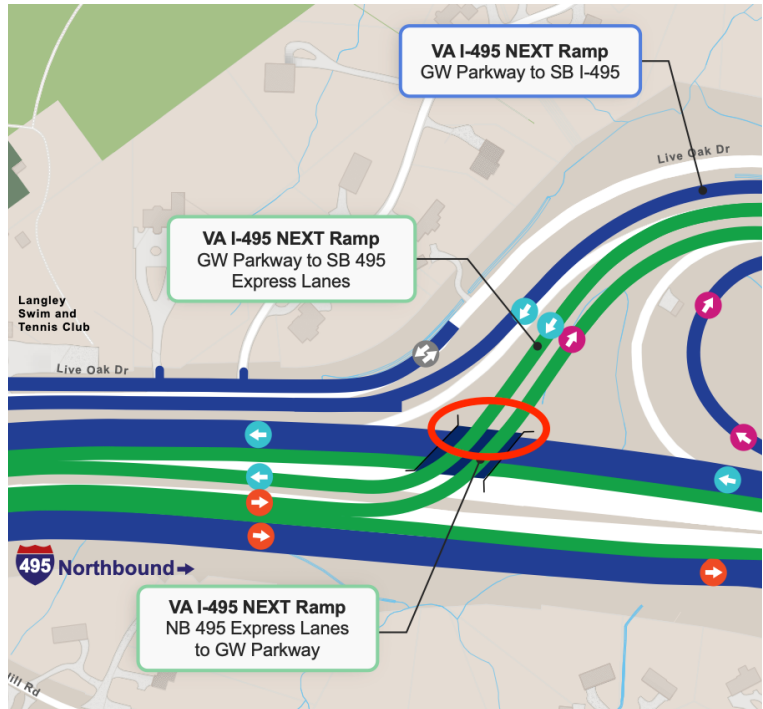

The 495 NEXT team appreciates the community's understanding as this impactful work progresses.



Pile driving will occur at the north abutments (red circle) of new ramps that will connect George Washington Memorial Parkway and I-495.

Construction plans are subject to change due to weather, utility relocations performed by outside companies, resequencing of work to facilitate on-time completion of the overall project, and other factors.

Stay Connected

-  495NorthernExtension@VDOT.Virginia.gov
-  John Undeland, Lane Construction: 703-785-3461
Construction Information Line: 703-592-6430
-  495NEXT.vdot.virginia.gov



SIGN UP FOR PROJECT EMAILS